



Register of Applications to Modify the Definitive Map and Statement

Parish: Heath & Reach

Path: FP 11 (new sections thereof) (if applicable)

Applicant's Details

Applicant: Identity Protected* [] Mr. Mike Clarke

Agent:

Bedfordshire Rights of Way Association 5 Tyrells End Eversholt MILTON KEYNES MK17 9DS

Claimed Modification

Claim: That two sections of footpath should be added to the Definitive Map for Heath & Reach

Supplied Evidence: Definitive Statement for Heath & reach Footpath No. 11 1961 Aerial photograph Extract from the Leighton Buzzard Inclosure Award (text and map) Ordnance Survey 25":1mile map 1st ed. of 1880 Ordnance Survey 25":1mile map 3rd ed. of 1926

* The Council has a right to protect the identity of an applicant if it considers that there is the possibility of intimidation or retribution occurring as a consequence of the application.

The Register of Applications to Modify the Definitive Map and Statement can also be accessed for free at the Countryside Access Service, County Hall, Cauldwell Street, Bedford, MK42 9AP during office hours. Please telephone 01234 276071 to make an appointment.

Submitted evidence can be viewed during office hours either at the Bedfordshire and Luton Archives at County Hall or at the Countryside Access Service by prior appointment.

Geographical Description of Route

From: Junction of FP 8 and FP 11 along alleyway to Lanes End and then...

OS Grid Reference SP 9245 2791

To: from junction of lanes and with alleyway to junction of southern end of alleyway with FP

OS Grid Reference SP 9231 2792

Path: FP 11 (new sections thereof)

Parish: Heath & Reach

District: South-beds District Council

PostTown: Leighton Buzzard

Affected Properties: Land Adj. 19, 30, 23-37, & 63-67 Lanes End, Heath & Reach, LU7 0AE [No landowners found - Notice posted on-site]

Location Plan: Please refer to the separate documents either shown overleaf or as links to separate PDF files shown on the main Register list.

County Council Information

Date Received: 02/04/2007

Current Action: PENDING

Committee Decision:

Application Rejected:

Orders Made:

ObjectionsReceived:

Secretary of State Directions:

Orders Confirmed:

Case Officer: File No:

This copy has been made by or with the authority of Bedfordshire County Council's Definitive Map Officer, pursuant to Section 47 of the Copyright, Designs and Patents Act 1988 ("the Act"). Unless the Act provides a relevant exception to copyright, the copy must not be copied without the prior permission of the copyright owner.

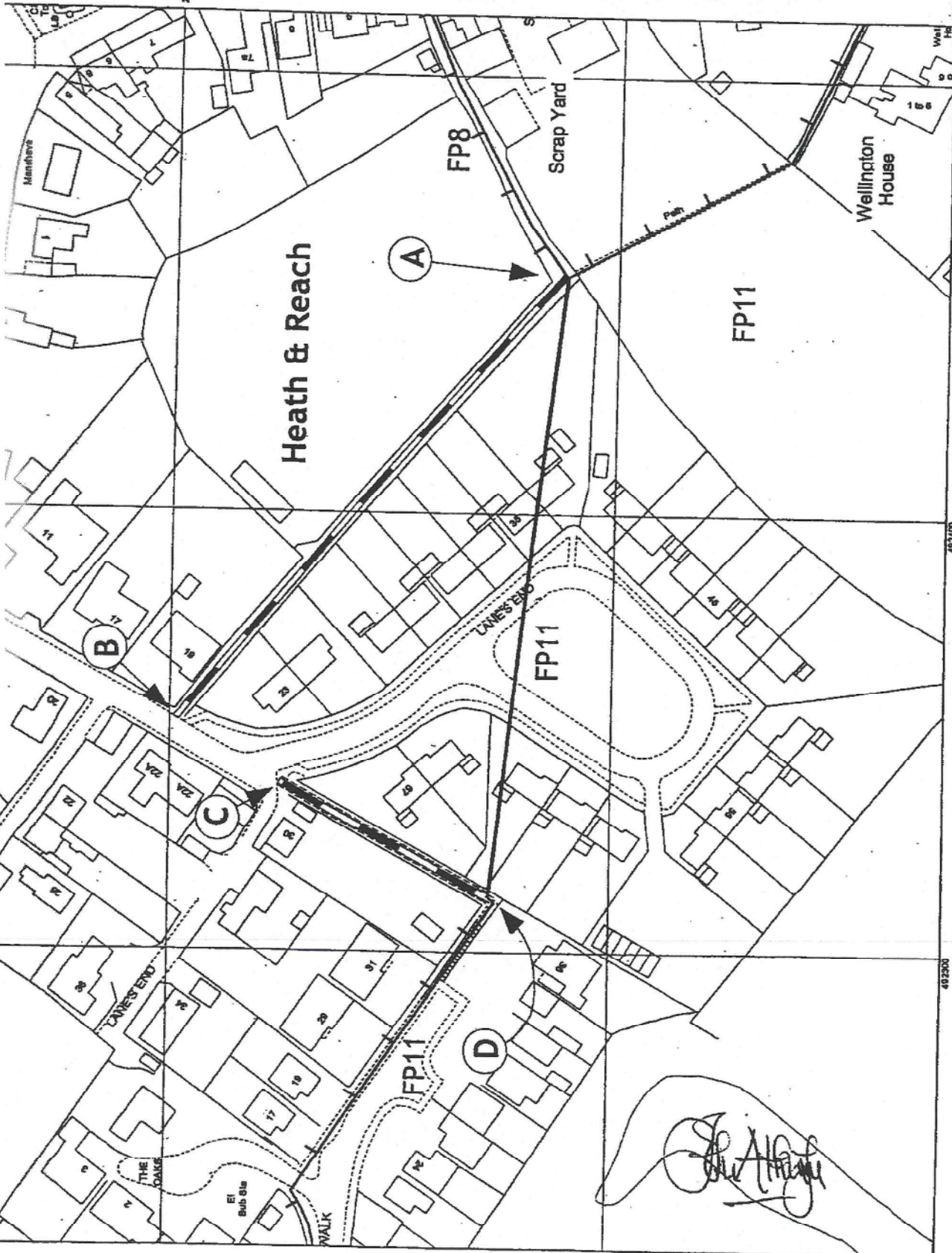

**REACH FOOTPATH
NO 11**

Path to be stopped up	A	D
New Route	A	B C D

Unaffected Public Footpath

Scale	Date	File Ref	North
1: 1250	July 03	HR/5/01	↖

Location Plan Scale 1: 50 000



Based on the Ordnance Survey Map with the permission of the Controller of HMSO.



Crown Copyright Reserved. Licence Number 076466LA

Bedfordshire
county council

[Handwritten signature]